

## Compatibility

-- 21 DV Fireplace

## Packing List

Firebox Liner

## Important Warnings

- Turn off gas to the appliance and make sure it has fully cooled prior to conducting service.
- The firebox liner is fragile – take care to prevent damage.
- The firebox liner leaves a slight white residue when touched – make sure to clean the area and your hands after handling the liner.

## Installation

- 1 Remove the face, glass, embers, and burner (see the owner's manual for details).
- 2 Follow the directions below to remove and discard the steel liner.

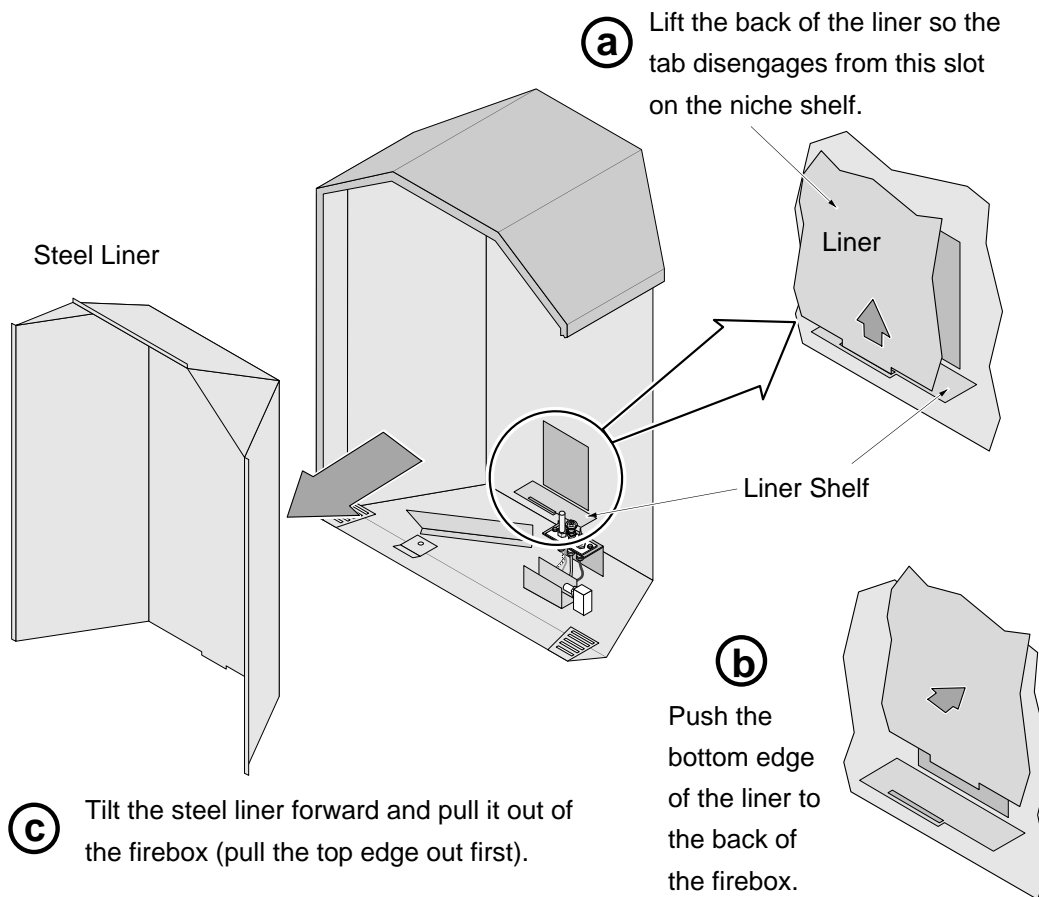

3 Install the liner following the directions below.



(a) Tilt the liner forward and at a slight angle as you insert it into the firebox.

Place the bottom left corner into the firebox first.



(b) As you insert the liner, **make sure the liner goes behind the pilot assembly.**



(c) The top of the liner will be very tight along the top – carefully rotate and tilt the liner into place.

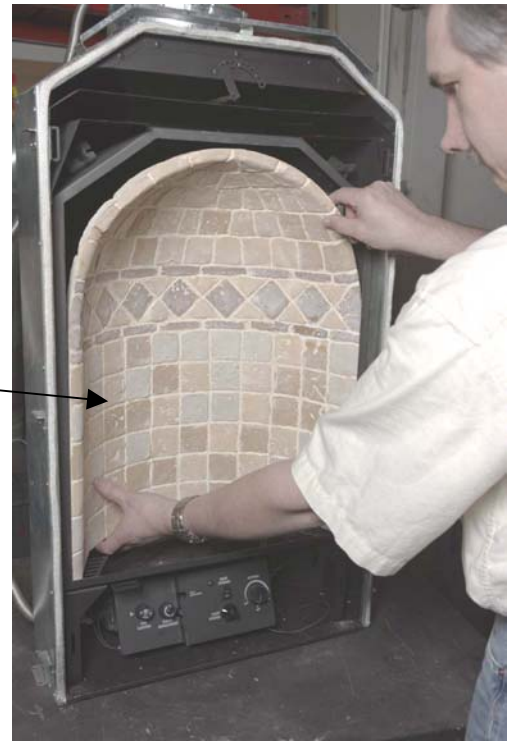

(d) Once in the firebox, pull the liner forward so it is against the front flanges of the firebox. Center the liner from side to side.

4 Replace the burner, logs, embers, glass, and face.