

# 564 HO GSR2 Cheat Sheet

The 564HO GSR2 has several new features and characteristics that require special attention during installation and set-up. This unit uses the new GreenSmart 2 system. Refer to the owner's manual for full details.

## Remote Control / Pilot Warnings



Installing batteries in the battery holder or connecting the appliance to power may automatically initiate the CPI pilot mode, resulting in a lit pilot flame. Do not place combustibles in the firebox.

### KEEP BATTERIES AND COVER INSTALLED AT ALL TIMES

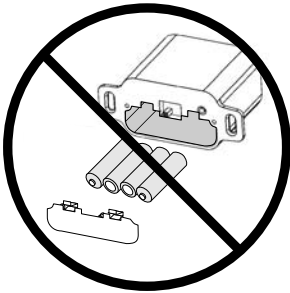

The remote control system requires the batteries and battery cover to remain in place at all times. Once the batteries or cover are removed, the system may re-start in standing pilot mode. If this occurs when the heater is in Remote Mode, you will not be able to turn the heater off manually from the battery box.

If you need to replace dead batteries, make sure to **turn the appliance off** before removing the batteries.

**NOTE:** If the batteries go dead, the system will operate normally as long as household power (120v AC) is present.

## Burner Kit and Media (logs/stones) Required

This fireplace is shipped without a burner. This allows the fireplace to be configured in one of three unique designs. See the table below to verify you have all of the items required.

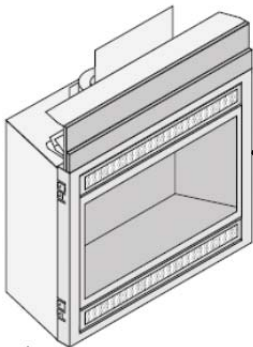

<u>Burner Style</u>	<u>EmberFyre™ Burner</u> 96900116	<u>DiamondFyre™ Burner</u> 96900115	<u>DancingFyre™ Burner</u> 96900114
<u>Firebacks</u>	Requires 564 <u>Ceramic</u> Firebacks. (use 96100179 Brick/Herringbone or other <u>ceramic</u> firebacks)	Requires one of the following: Stainless 96100249 Enamel Black 96100250 Painted Black 96100251	Included w Burner (Black Painted)
<u>Logs/Media</u>	Included w Burner	Use 564 HO (31 DVI) Media Driftwood (94500548) Other Media To Follow	Included w Burner
<u>Face/Grill</u>	Use any 564 Face or Grill	Use any 564 Face or Grill	Use any 564 Face or Grill

## If using LP (Propane)

A conversion kit is required if using propane with this heater (sku 94400999 – GSR Stepper Motor Kit).

## Venting Warnings

- **Intake Restrictor Shipped with Burner** See the burner installation instructions for installing the intake restrictor.
- **Vent Configuration Settings Differ Between Burners** Because the unique burners affect airflow, the EmberFyre™ and DancingFyre™/DiamondFyre™ have different vent configuration settings (and intake restrictors). Follow the instructions in the manual to insure the correct setting.

**NOTE: Travis Industries recommends using a 6-5/8" diameter vent when terminating vertically.**

- **Bend the Pipe Shield Vertical After the Fireplace is in the Framing** The pipe shield protects the header from heat. After the fireplace is in place, and before you install the vent, bend the pipe shield to a vertical position.
- **Unique Thimble Required for Wall Penetrations** This fireplace uses a specialized wall thimble to allow the vent to pass through a wall. One thimble is included, but if a second wall penetration is made, make sure to order an additional one (sku 250-02318).

## **WARNING:**

Sheet metal edges can be sharp

---

## **ADVERTENCIA:**

Los bordes de chapa metálica pueden estar afilados

### **CAUTION: RESTRICTOR ADJUSTMENT REQUIRED**

This heater will not operate properly if the vent restrictor is not set for your specific installation. See "Vent configuration" section in the owner's installation manual.

### **FIRST FIRE OR START UP**

Your appliance has been finished with the highest quality paint. Though this paint dries quickly to the touch, it does not cure or become hard until heated up by the appliance during first fire. For this reason the stove will emit light smoke and have a slight odor. Consult your owner's manual for the complete paint curing instructions. Partially open doors or windows to minimize smoke & odor.

---

### **LA PRECAUCIÓN: EL AJUSTE DE RESTRICTOR REQUERIDO**

Este calentador no funcionará apropiadamente si el restrictor de abertura no está previsto para su instalación específica. See "La configuración de abertura" corte transversal en el manual de instalación del propietario.

### **EL PRIMERO FUEGO O COMIENZA PARA ARRIBAS**

Su aparato ha estado terminado con la pintura de mejor calidad. Aunque esta pintura se seca rápidamente al tacto, no hace la cura o becomeve duro until calienta por el aparato durante el primer fuego. Para esta razón la cocina emitirá humo ligero y tendrá un olor leve. Consulte el manual de su propietario para la pintura completa curar las instrucciones. Abra puertas o ventanas parcialmente para minimizar humo & olor.